

## MS-700 Dumps

### Managing Microsoft Teams

<https://www.certleader.com/MS-700-dumps.html>

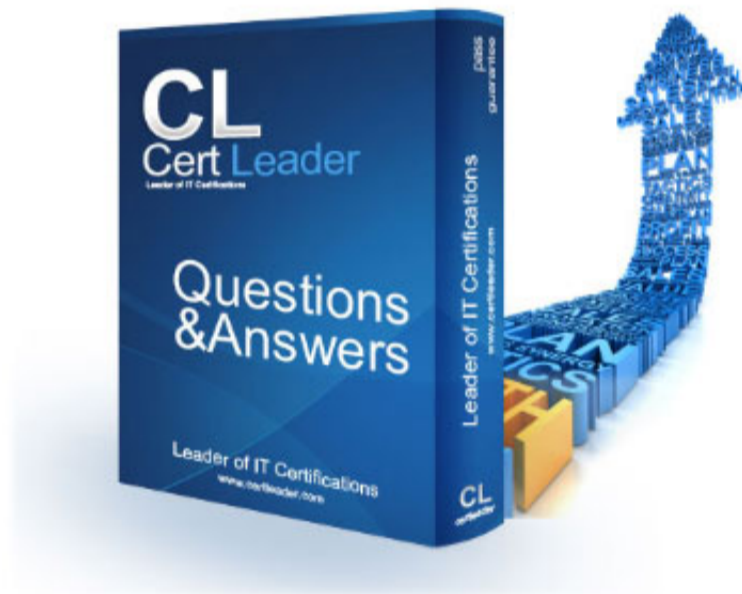

**NEW QUESTION 1**

- (Exam Topic 1)

You need to configure the environment to meet the technical requirements for guest users. What should you modify from the Microsoft Teams admin center?

- A. the global app permission policy
- B. the Org-wide settings
- C. the global meeting policy
- D. the global messaging policy

**Answer: B**

**Explanation:**

Microsoft Teams admin center > Org-wide settings > Guest access > Make private calls = off.

**NEW QUESTION 2**

- (Exam Topic 1)

During the pilot project, you review the global policies in the Microsoft Teams admin center. Contoso has a global meeting policy configured as shown in the following exhibit.

**Participants & guests**

Participant and guest settings let you control access to Teams meetings for people that dial in using a phone. [Learn more](#)

Let anonymous people start a meeting ⓘ	<input checked="" type="checkbox"/> On
Automatically admit people ⓘ	Everyone in your organization and federated organizations ▾
Allow dial-in users to bypass the lobby ⓘ	<input type="checkbox"/> Off
Allow Meet now in private meetings	<input checked="" type="checkbox"/> On
Enable live captions	Enabled ▾
Allow chat in meetings	Enabled ▾

Contoso has a global live events policy configured as shown in the following exhibit.

**Live events policies \ Global**

**Global**

Description

Allow scheduling	<input checked="" type="checkbox"/> On
Allow transcription for attendees	<input checked="" type="checkbox"/> On
Who can join scheduled live events	Everyone ▾
Who can record an event	Always record ▾

For each of the following statements, select Yes if the statement is true. Otherwise, select No.

NOTE: Each correct selection is worth one point.

Statements	Yes	No
The policies meet Requirement1 for meeting and live events.	<input type="radio"/>	<input type="radio"/>
The policies meet Requirement2 for meeting and live events.	<input type="radio"/>	<input type="radio"/>
The policies meet Requirement3 for meeting and live events.	<input type="radio"/>	<input type="radio"/>

- A. Mastered
- B. Not Mastered

**Answer: A**

**Explanation:**

Statements	Yes	No
The policies meet Requirement1 for meeting and live events.	<input checked="" type="radio"/>	<input type="radio"/>
The policies meet Requirement2 for meeting and live events.	<input checked="" type="radio"/>	<input type="radio"/>
The policies meet Requirement3 for meeting and live events.	<input type="radio"/>	<input checked="" type="radio"/>

### NEW QUESTION 3

- (Exam Topic 1)

You need to resolve the notification issues identified during the pilot project. What should you modify?

- A. the global meeting policy
- B. the global messaging policy
- C. the org-wide Teams settings
- D. the app permission policy

**Answer:** B

#### Explanation:

<https://docs.microsoft.com/en-us/microsoftteams/messaging-policies-in-teams>

### NEW QUESTION 4

- (Exam Topic 2)

You need to configure Microsoft Teams to meet the department upgrade requirements.

For each of the following statements, select Yes if that statement is true. Otherwise, select No.

NOTE: Each correct selection is worth one point.

Statements	Yes	No
The Microsoft Teams upgrade policy be set to Skype for Business with Teams collaboration and meetings coexistence mode for the sales department users.	<input type="radio"/>	<input type="radio"/>
The Microsoft Teams upgrade policy be set to Skype for Business only coexistence mode for the HR department users.	<input type="radio"/>	<input type="radio"/>
The Microsoft Teams upgrade policy be set to Teams only coexistence mode for the IT department users.	<input type="radio"/>	<input type="radio"/>

- A. Mastered
- B. Not Mastered

**Answer:** A

#### Explanation:

Reference:

<https://docs.microsoft.com/en-us/microsoftteams/teams-and-skypeforbusiness-coexistence-and-interoperability>

### NEW QUESTION 5

- (Exam Topic 2)

You need to recommend a solution to perform the network validation tasks for the platform upgrade. Which tool and role should you recommend for each user? To answer, select the appropriate options in the answer area.

NOTE: Each correct selection is worth one point.

User name	Tool	Role
Admin5	<div>▼</div> <div>Microsoft Call Quality Dashboard</div> <div>Network Monitor</div> <div>Network Planner</div> <div>Network Testing Companion</div>	<div>▼</div> <div>Teams Communications Administrator</div> <div>Teams Communications Support Engineer</div> <div>Teams Communications Support Specialist</div>
Admin6	<div>▼</div> <div>Microsoft Call Quality Dashboard</div> <div>Network Monitor</div> <div>Network Planner</div> <div>Network Testing Companion</div>	<div>▼</div> <div>Teams Communications Administrator</div> <div>Teams Communications Support Engineer</div> <div>Teams Communications Support Specialist</div>

- A. Mastered  
B. Not Mastered

**Answer:** A

**Explanation:**

Reference:

<https://docs.microsoft.com/en-us/microsoftteams/network-planner>

<https://docs.microsoft.com/en-us/microsoftteams/difference-between-call-analytics-and-call-quality-dashboard>

**NEW QUESTION 6**

- (Exam Topic 2)

What should you recommend to meet the Microsoft Teams requirements for guest access?

- A. From the Azure Active Directory admin center, modify the External collaboration settings to include fabrikam.com only.  
B. From the Microsoft 365 admin center, modify the Office 365 groups settings.  
C. From the External access settings in the Microsoft Teams admin center, add fabrikam.com to the Allowed list of domains.  
D. From the Microsoft Teams admin center, turn off org-wide guest access and manually add guest users from fabrikam.com to teams.

**Answer:** A

**Explanation:**

<https://docs.microsoft.com/en-us/azure/active-directory/b2b/delegate-invitations> <https://docs.microsoft.com/en-us/microsoftteams/manage-external-access>

<https://docs.microsoft.com/en-us/azure/active-directory/b2b/allow-deny-list>

**NEW QUESTION 7**

- (Exam Topic 2)

You need to identify the requirements for the voice pilot project.

Which two actions should you perform? Each correct answer presents part of the solution.

NOTE: Each correct selection is worth one point.

- A. Assign an additional license and phone number to each user.  
B. Deploy a Session Border Controller (SBC) for Litware.  
C. Purchase a Calling Plan for each user.  
D. Create a dial plan for Litware.  
E. Purchase a Calling Plan for Litware.

**Answer:** AC

**NEW QUESTION 8**

- (Exam Topic 3)

Your company has a Microsoft 365 subscription. The subscription contains 200 Microsoft Teams users and a team named IT Support that has 50 members.

You need to ensure that the caller ID for outbound PSTN calls from IT Support is the phone number of the company's IT helpdesk. The solution must minimize administrative effort.

Which two tools should you include in the solution? Each correct answer presents part of the solution.

NOTE: Each correct selection is worth one point.

- A. the Microsoft Teams PowerShell module  
B. the Azure Active Directory (Azure AD) PowerShell for Graph module  
C. the Call Quality Dashboard (CQD)  
D. the Windows PowerShell module for Microsoft Skype for Business Online  
E. the Skype for Business admin center

**Answer:** AE

**Explanation:**

Reference:

<https://docs.microsoft.com/en-us/powershell/module/skype/new-cscallinglineidentity?view=skype-ps> <https://docs.microsoft.com/en-us/microsoftteams/assign->

policies#assign-a-policy-to-a-group

#### NEW QUESTION 9

- (Exam Topic 3)

Your company has a Microsoft 365 subscription.

You need to prevent guest users from creating or updating channels.

How should you complete the PowerShell script? To answer, drag the appropriate options to the correct targets. Each option may be used once, more than once, or not at all. You may need to drag the split bar between panes or scroll to view content.

NOTE: Each correct selection is worth one point.

Terms	Answer Area
Get-AzureADGroup	Value   Value -AllowGuestCreateUpdateChannels \$false
Get-AzureADUser	
Get-Team	
Set-AzureADGroup	
Set-AzureADUser	
Set-Team	

- A. Mastered
- B. Not Mastered

**Answer:** A

#### Explanation:

Reference:

<https://docs.microsoft.com/en-us/powershell/module/teams/get-team?view=teams-ps> <https://docs.microsoft.com/en-us/powershell/module/teams/set-team?view=teams-ps>

#### NEW QUESTION 10

- (Exam Topic 3)

Your company has a Microsoft Office 365 subscription.

The company has three departments. Each department contains a group as shown in the following table.

Department name	Type
HR	Distribution
R&D	Global security
Sales	Universal security

You plan to create a team for each group.

You need to ensure that a team can be created for each group. The solution must minimize administrative effort.

What should you do to each group? To answer, select the appropriate options in the answer area.

NOTE: Each correct selection is worth one point.

HR:	<div>▼</div> <div>Change the group to an Office 365 group.</div> <div>Recreate the group as an Office 365 group.</div> <div>Change the group to a security group.</div>
R&D:	<div>▼</div> <div>Change the group to an Office 365 group.</div> <div>Recreate the group as an Office 365 group.</div> <div>Change the group to a universal group.</div>
Sales:	<div>▼</div> <div>Change the group to an Office 365 group.</div> <div>Recreate the group as an Office 365 group.</div> <div>Change the group to a global group.</div>

- A. Mastered
- B. Not Mastered

**Answer:** A

**Explanation:**

HR:	<div><div></div><div>▼</div></div>
Change the group to an Office 365 group.	
Recreate the group as an Office 365 group.	
Change the group to a security group.	

R&D:	<div><div></div><div>▼</div></div>
Change the group to an Office 365 group.	
Recreate the group as an Office 365 group.	
Change the group to a universal group.	

Sales:	<div><div></div><div>▼</div></div>
Change the group to an Office 365 group.	
Recreate the group as an Office 365 group.	
Change the group to a global group.	

#### NEW QUESTION 10

- (Exam Topic 3)

Your company has a Microsoft 365 subscription.

An administrator reports that teams were deleted accidentally today. You need to restore the teams as quickly as possible.

Which cmdlets should you run?

- A. Get-AzureADMSDeletedGroup and Restore-AzureADMSDeletedDirectoryObject
- B. Get-Team and Restore-ADObject
- C. Get-AzureADMSDeletedGroup and Restore-ADObject
- D. Get-AzureADGroup and Restore-AzureADMSDeletedDirectoryObject
- E. Get-Team and Restore-AzureADMSDeletedDirectoryObject

**Answer:** A

**Explanation:**

Reference:

D18912E1457D5D1DDCBD40AB3BF70D5D

<http://www.mytechnetblog.com/2020/01/recover-deleted-teams.html>

#### NEW QUESTION 13

- (Exam Topic 3)

Your company has a Microsoft 365 subscription that contains 20 teams.

You need to ensure that a team named Team1 is identified as Highly Confidential in the Microsoft Teams client.

What should you use?

- A. a classification label in the Azure Active Directory admin center
- B. a sensitivity label in the Security & Compliance admin center
- C. a supervisor policy in the Security & Compliance admin center
- D. a teams policy in the Microsoft Teams admin center

**Answer:** B

**Explanation:**

<https://docs.microsoft.com/en-us/microsoft-365/compliance/sensitivity-labels-teams-groups-sites>

#### NEW QUESTION 17

- (Exam Topic 3)

Note: This question is part of a series of questions that present the same scenario. Each question in the series contains a unique solution that might meet the stated goals. Some question sets might have more than one correct solution, while others might not have a correct solution.

After you answer a question in this section, you will NOT be able to return to it. As a result, these questions will not appear in the review screen.

Your company has a Microsoft 365 subscription.

You plan to configure the environment to allow external users to collaborate in Microsoft Teams by using guest access.

The company implements a new security policy that has the following requirements:

- Only guest users from specific domains must be allowed to connect to collaborate by using Microsoft Teams.

➤ Guest users must be prevented from inviting other guests.  
You need to recommend a solution to meet the security policy requirements.  
Solution: From the Microsoft Teams admin center, you modify the global meeting policy. Does this meet the goal?

- A. Yes
- B. No

**Answer:** B

**Explanation:**

<https://docs.microsoft.com/en-us/microsoftteams/meeting-policies-in-teams>

**NEW QUESTION 22**

- (Exam Topic 3)

You have a Microsoft 365 subscription that uses Microsoft Teams and contains the users shown in the following table.

Name	Role
Admin1	Global Administrator
Admin2	Teams Administrator

You have a team named Project1 that contains the members shown in the following table.

Name	Role
User1	Owner
User2	Member

You need to monitor Project1 for the following administrative actions:

- The creation and deletion of channels
- Changing the role assignments of team members

Which users can monitor Project1, and which feature should the users use? To answer, select the appropriate options in the answer area.

NOTE: Each correct selection is worth one point.

Feature:

	▼
Audit log	
Usage reports	
Teams advisor	
Content search	
Message center	

Users:

	▼
User1 only	
Admin1 only	
Admin2 only	
Admin1 and Admin2 only	
User1, Admin1, and Admin2	

- A. Mastered
- B. Not Mastered

**Answer:** A

**Explanation:**

Graphical user interface, text, application, table Description automatically generated

Reference:

<https://docs.microsoft.com/en-us/microsoftteams/audit-log-events>

<https://docs.microsoft.com/en-us/microsoft-365/security/office-365-security/permissions-in-the-security-and-co>

**NEW QUESTION 24**

- (Exam Topic 3)

Note: This question is part of a series of questions that present the same scenario. Each question in the series contains a unique solution that might meet the stated goals. Some question sets might have more than one correct solution, while others might not have a correct solution.

After you answer a question in this section, you will NOT be able to return to it. As a result, these questions will not appear in the review screen.

You company has a Microsoft 365 subscription and a Virtual Desktop Infrastructure (VDI) solution. The company's Microsoft Teams upgrade policy is set to Teams only coexistence mode.

You deploy the Microsoft Installer (MSI) package for Microsoft Teams to the VDI solution.

Several months later, users of the VDI solution report that their workstation is missing several new Microsoft Teams features.

You need to ensure that the VDI solution users can use the new Microsoft Teams features.

Solution: You run the Grant-CsTeamsUpgradePolicy cmdlet and specify the -PolicyName parameter. Does this meet the goal?

A. Yes

B. No

**Answer: B**

**Explanation:**

Reference:

<https://docs.microsoft.com/en-us/microsoftteams/teams-client-update> <https://docs.microsoft.com/en-us/microsoftteams/teams-for-vdi#install-teams-on-vdi>

#### NEW QUESTION 29

- (Exam Topic 3)

Your company has a Microsoft 365 subscription that contains three groups named HR, Marketing, and Sales.

You need to configure the Microsoft Teams desktop client. The solution must meet the following requirements:

- Members of the HR group must be prevented from pinning apps to their app bar.
- Members of the Marketing group must have the Microsoft Planner app pinned to their app bar.
- Members of the Sales group must not be affected by policies applied to the Marketing and HR groups. Which two actions should you perform? Each correct answer presents part of the solution.

NOTE: Each correct selection is worth one point.

A. Modify the global app setup policy.

B. Modify the global app permission policy.

C. Create an app setup policy for HR.

D. Create an app setup policy for Marketing.

E. Create an app permission policy for Marketing.

F. Create an app permission policy for HR.

**Answer: CD**

**Explanation:**

Reference:

<https://docs.microsoft.com/en-us/microsoftteams/teams-app-setup-policies>

#### NEW QUESTION 31

- (Exam Topic 3)

You have a Microsoft 365 subscription that uses Microsoft Teams and contains a user named User1 and three groups named Group1 , Group2 and Group3. User1 is a member of Group1, Group2, and Group3.

The subscription has the meeting policies shown in the following table.

Name	Configuration
Global (Org-wide default)	Meet now in channels: On Transcription: Off
Policy1	Meet now in channels: Off Transcription: Off
Policy2	Meet now in channels: On Transcription: Off

Statements	Yes	No
Meet now in channels is turned off for User1.	<input type="radio"/>	<input type="radio"/>
Transcription is turned off for User1.	<input type="radio"/>	<input type="radio"/>
The Global (Org-wide default) policy applies to User1.	<input type="radio"/>	<input type="radio"/>

A. Mastered

B. Not Mastered

**Answer: A**

**Explanation:**

Graphical user interface, text, application Description automatically generated with medium confidence

**NEW QUESTION 34**

- (Exam Topic 3)

Your company has a Microsoft 365 subscription that contains several teams.

The company's security policy states that an administrator must be notified when a new team is created by using the Build a team from scratch option.

You need to configure the environment to meet the security policy requirement. What should you do?

- A. From the Security & Compliance admin center, create a supervision policy.
- B. From the Security & Compliance admin center, create an alert policy.
- C. From the Azure Active Directory admin center, create a protection notification.
- D. From the Microsoft Teams admin center, modify the global teams policy.

**Answer: B**

**NEW QUESTION 36**

- (Exam Topic 3)

You have a Microsoft 365 E5 subscription that uses Teams.

You need to ensure that all the files in Teams channels are stored for at least one year after the files are deleted.

What should you do?

- A. Create an Audit retention policy.
- B. Enable Customer Lockbox.
- C. Create a data loss prevention (DIP) policy for Teams chat and channel messages.
- D. Create a retention policy for Microsoft SharePoint sites.

**Answer: D**

**Explanation:**

<https://docs.microsoft.com/en-us/microsoft-365/compliance/retention-policies-teams?view=o365-worldwide>

**NEW QUESTION 41**

- (Exam Topic 3)

Your company has a Microsoft 365 subscription. You add guest users to the organization. The company's global live event policy is configured as shown in the following exhibit.



Use the drop-down menus to select the answer choice that completes each statement based on the information presented in the graphic.

NOTE: Each correct selection is worth one point.

[Answer choice] can access live events.

	▼
Users who have an Azure AD account, external access users, and guest users	
Only users who have an Azure AD account and external access users	
Only users who have an Azure AD account and guest users	
Only users who have an Azure AD account only	

[Answer choice] can schedule live events.

	▼
All users who have an Azure AD account	
All users who have an Azure AD account and guest users	
Only global administrators	
Only team owners	

- A. Mastered
- B. Not Mastered

**Answer: A**

**Explanation:**

Reference:

<https://docs.microsoft.com/en-us/microsoftteams/teams-live-events/set-up-for-teams-live-events>

**NEW QUESTION 44**

- (Exam Topic 3)

You have a Microsoft 365 subscription.

You create an org-wide team named Team1. Users named User1 and User2 are the owners of Team1. You need to configure Team1 to meet following requirements:

- Ensure that only User1 and User2 can create new posts in the General channel.
- Prevent @mentions for the org-wide team members.

Which two actions should you perform from the Microsoft Teams client? Each correct answer presents part of the solution.

NOTE: Each correct selection is worth one point.

- A. From the Team1 settings, clear Give members the option to edit their messages
- B. From the General Channel settings of Team1, set the channel moderation preference to Anyone can post; show alert that postings will notify everyone (recommended for large teams)
- C. From the General Channel settings of Team1. set the channel moderation preference to Only owners can post messages.
- D. From the Team1 settings, disable all the Fun stuff settings.
- E. From the Team1 settings, set Show members the option to @team or @[team name] to Off.

**Answer:** CE

**Explanation:**

Reference:

<https://docs.microsoft.com/en-us/microsoftteams/create-an-org-wide-team>

#### NEW QUESTION 46

- (Exam Topic 3)

Your company has a Microsoft 365 subscription.

You need to prevent users from using Microsoft Teams to communicate with users in a partner company that uses an email domain named litewareinc.com.

What should you do from the Microsoft Teams admin center?

- A. Turn off guest access.
- B. Create a new messaging policy.
- C. Modify the External access settings.
- D. Create a new meeting policy.

**Answer:** C

#### NEW QUESTION 48

- (Exam Topic 3)

You open the Microsoft Call Quality Dashboard as shown in the following exhibit.

##### All Audio Streams

This Report shows the monthly audio streams count, and poor ration for the last 7 months. There are no filters applied so the data reflects all the call data that was captured by the Service. Audio calls made over wireless and external networks can cause poor call rates to go up.

Edit Clone ...

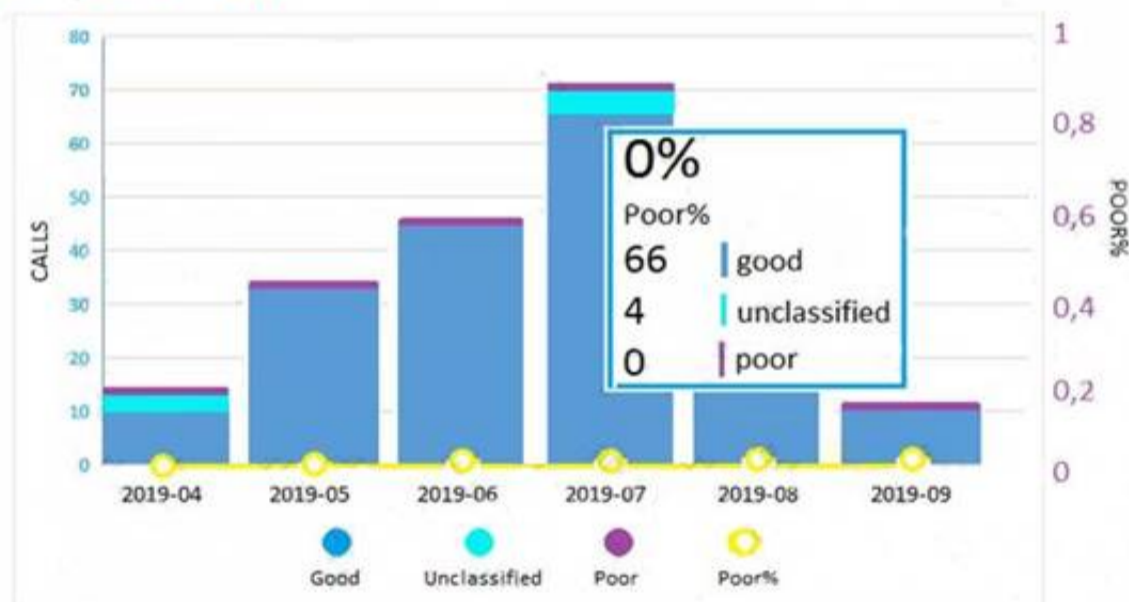

Use the drop-down menus to select the answer choice that completes each statement based on the information presented in the graphic.

NOTE: Each correct selection is worth one point.

During the month of July 2019, [answer choice]  
calls were established successfully.

	▼
0	
4	
66	
70	

During the month of July 2019, [answer choice]  
calls included metric data.

	▼
0	
4	
66	
70	

- A. Mastered
- B. Not Mastered

**Answer:** A

**Explanation:**

During the month of July 2019, [answer choice]  
calls were established successfully.

	▼
0	
4	
66	
70	

During the month of July 2019, [answer choice]  
calls included metric data.

	▼
0	
4	
66	
70	

#### NEW QUESTION 49

- (Exam Topic 3)

You have a Microsoft 365 subscription that uses Microsoft Teams.

You plan to implement Microsoft Teams Rooms. The solution must meet the following requirements:

- Ensure that Microsoft manages firmware and application updates for room systems and peripherals.
- Ensure that Microsoft monitors and troubleshoots room system and peripherals.

Which license should you purchase?

- A. Advanced Communications
- B. Microsoft Teams Rooms Premium
- C. Microsoft Teams Rooms Standard
- D. Microsoft 365 Business Voice

**Answer:** B

**Explanation:**

Reference:

<https://docs.microsoft.com/en-us/microsoftteams/rooms/rooms-licensing> <https://docs.microsoft.com/en-us/microsoftteams/rooms/microsoft-teams-rooms-premium>

#### NEW QUESTION 50

- (Exam Topic 3)

Your company has a Microsoft 365 subscription.

You need to ensure that users from a partner company named Contoso, Ltd. can collaborate with your company's users in teams. The solution must ensure that the Contoso users can exchange chat messages in channels.

Which three actions should you perform before you add the Contoso users to teams? Each correct answer presents part of the solution.

NOTE: Each correct selection is worth one point.

- A. From the Services & add-ins settings in the Microsoft 365 admin center, set Let group members outside the organization access group content to On.
- B. From the Guest access settings in the Microsoft Teams admin center, set Allow guest access in Microsoft Teams to On.
- C. From the External collaboration settings in the Azure Active Directory admin center, add Contoso's domain to the list of target domains.
- D. From the External access settings in the Microsoft Teams admin center, add Contoso's domain to the Allowed list of domains.
- E. From the External collaboration settings in the Azure Active Directory admin center, set Guest users permissions are limited to No.

F. From the Services & add-ins settings in the Microsoft 365 admin center, set Let group owners add people outside the organization to groups to On.

**Answer:** BDF

**Explanation:**

Reference:

<https://docs.microsoft.com/en-us/microsoftteams/manage-external-access> <https://docs.microsoft.com/en-us/microsoftteams/teams-dependencies>

#### NEW QUESTION 52

- (Exam Topic 3)

You have a Microsoft 365 E5 subscription that is linked to an Azure Active Directory (Azure AD) tenant. The tenant contains the groups shown in the following table.

Name	Type
Group1	Distribution
Group2	Security
Group3	Microsoft 365
Group4	Mail-enabled security

You need to create a new team by using the Microsoft Teams client. Which group can you use to create the new team?

- A. Group4
- B. Group1
- C. Group2
- D. Group3

**Answer:** D

**Explanation:**

Reference:

<https://support.microsoft.com/en-us/office/create-a-team-from-an-existing-group-24ec428e-40d7-4a1a-ab87-29b>

#### NEW QUESTION 56

- (Exam Topic 3)

Your company has a Microsoft 365 subscription.

You plan to enable users to book meetings in several of the company's conference rooms by using the Microsoft Teams client.

You need to create the required resources in Microsoft 365 for the conference rooms. What should you create for each conference room?

- A. a team
- B. a resource mailbox
- C. an auto attendant
- D. an Office 365 group

**Answer:** B

**Explanation:**

Reference:

<https://docs.microsoft.com/en-us/microsoftteams/rooms/rooms-deploy>

#### NEW QUESTION 59

- (Exam Topic 3)

Your company has a Microsoft 365 subscription.

A user invites an external user to join a Microsoft Teams meeting by using a Microsoft Outlook meeting invitation.

The external user cannot join the meeting.

You need to ensure that all external users can join Microsoft Team meetings. What should you do from the Microsoft Teams admin center?

- A. From Guest access in the Org-wide settings, set Allow guest access in Microsoft Teams to On.
- B. Edit the Meeting settings and set Anonymous users can join a meeting to On.
- C. Edit the global meeting policy and set Allow scheduling private meetings to On.
- D. Edit the live events policy and set Who can join live events to Everyone.

**Answer:** B

**Explanation:**

Reference:

<https://docs.microsoft.com/en-us/microsoftteams/meeting-settings-in-teams>

#### NEW QUESTION 64

- (Exam Topic 3)

Your company has a Microsoft 365 subscription. You need to review the following information:

- The Rate My Call data provided by users.
- The number of Microsoft Teams live event views from the past three months.

What should you use to view the information? To answer, select the appropriate options in the answer area.

The Rate My Call data provided by users:

	▼
Analytics & reports in the Microsoft Teams admin center	
Call History in the Microsoft Teams admin center	
Microsoft Call Quality Dashboard	
Microsoft Office 365 usage reports	

The number of Microsoft Teams live event views from the past three months:

	▼
Analytics & reports in the Microsoft Teams admin center	
Call History in the Microsoft Teams admin center	
Microsoft Call Quality Dashboard	
Microsoft Office 365 usage reports	

- A. Mastered  
B. Not Mastered

**Answer:** A

**Explanation:**

Reference:

<https://docs.microsoft.com/en-us/microsoftteams/turning-on-and-using-call-quality-dashboard> <https://docs.microsoft.com/en-us/microsoftteams/teams-analytics-and-reports/teams-live-event-usage-report>

**NEW QUESTION 69**

- (Exam Topic 3)

Note: This question is part of a series of questions that present the same scenario. Each question in the series contains a unique solution that might meet the stated goals. Some question sets might have more than one correct solution, while others might not have a correct solution.

After you answer a question in this section, you will NOT be able to return to it. As a result, these questions will not appear in the review screen.

Your company has a Microsoft 365 subscription that uses an Azure Active Directory (Azure AD) tenant named contoso.com.

You need to prevent guest users in the tenant from using cameras during Microsoft Teams meetings. Solution: From Microsoft Teams admin center, you modify the Guest access settings.

Does this meet the goal?

- A. Yes  
B. No

**Answer:** A

**Explanation:**

Guest access in Teams allows people outside your organization to access teams and channels. When you turn on Guest Access, you can turn on or off features guests users can or can't use.

Reference:

<https://docs.microsoft.com/en-us/microsoftteams/set-up-guests>

**NEW QUESTION 72**

- (Exam Topic 3)

Note: This question is part of a series of questions that present the same scenario. Each question in the series contains a unique solution that might meet the stated goals. Some question sets might have more than one correct solution, while others might not have a correct solution.

After you answer a question in this section, you will NOT be able to return to it. As a result, these questions will not appear in the review screen.

Your company has a Microsoft 365 subscription.

You need to prevent a user named User1 from permanently deleting private chats in Microsoft Teams. Solution: You create an In-Place Hold for the Microsoft OneDrive for Business site of User1.

Does this meet the goal?

- A. Yes  
B. No

**Answer:** B

**Explanation:**

Private chats are stored in user mailboxes, not on OneDrive.

**NEW QUESTION 77**

- (Exam Topic 3)

Your company has a Microsoft 365 subscription.

You have a Microsoft Teams team named Sales that is set to Private.

Users report that they can view the Sales team from a list of suggested teams. You need to hide the team from the list of suggested teams.

What should you do from the Microsoft Teams client?

- A. Modify the Team discovery settings.  
B. Select the Hide team option.  
C. Modify the team privacy settings.

D. Modify the team member permissions.

**Answer:** A

**Explanation:**

Reference:

<https://docs.microsoft.com/en-us/microsoftteams/manage-discovery-of-private-teams#set-whether-existingprivat>

**NEW QUESTION 80**

- (Exam Topic 3)

Note: This question is part of a series of questions that present the same scenario. Each question in the series contains a unique solution that might meet the stated goals. Some question sets might have more than one correct solution, while others might not have a correct solution.

After you answer a question in this section, you will NOT be able to return to it. As a result, these questions will not appear in the review screen.

Your company has a Microsoft 365 subscription.

You need to prevent a user named User1 from permanently deleting private chats in Microsoft Teams. Solution: You place the mailbox of User1 on Litigation Hold.

Does this meet the goal?

A. Yes

B. No

**Answer:** A

**NEW QUESTION 84**

- (Exam Topic 3)

Your company has a Microsoft 365 subscription.

The company's only messaging policy is a global messaging policy configured as shown in the following exhibit.

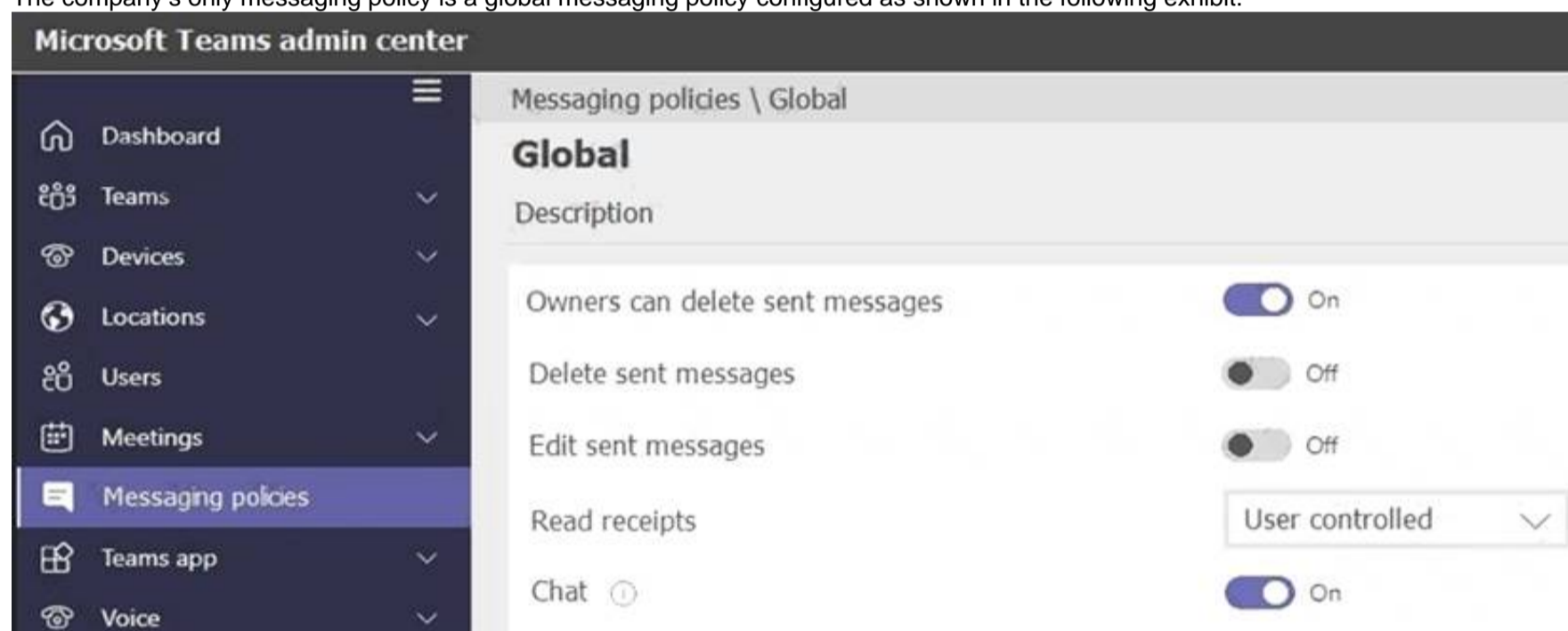

Use the drop-down menus to select the answer choice that completes each statement based on the information presented in the graphic.

NOTE: Each correct selection is worth one point.

Users [answer choice] sent chat messages.

	▼
can only delete	
can only modify	
can delete and modify	
cannot delete and modify	

Team owners [answer choice] sent chat messages.

	▼
can only delete	
can only modify	
can delete and modify	
cannot delete and modify	

A. Mastered

B. Not Mastered

**Answer:** A

**Explanation:**

Reference:

<https://docs.microsoft.com/en-us/microsoftteams/messaging-policies-in-teams>

**NEW QUESTION 89**

- (Exam Topic 3)

Your company has a Microsoft 365 subscription that uses Phone System. You need to configure Microsoft Teams to meet the following requirements:

- Ensure that calls to the company's sales department are routed to multiple users in the sales department.
- Ensure that calls to the company's marketing department are routed to multiple users in the marketing department.
- Outside of business hours, ensure that calls from PSTN users receive a custom greeting.
- During business hours, ensure that calls from PSTN users can be received by the sales and marketing department users.

What is the minimum number of auto attendants and call queues you should configure to meet the requirements? To answer, select the appropriate options in the answer area.

NOTE: Each correct selection is worth one point.

Auto attendants:

	▼
0	
1	
2	
3	

Call queues:

	▼
0	
1	
2	
3	

- A. Mastered
- B. Not Mastered

**Answer:** A

**Explanation:**

Reference:

<https://docs.microsoft.com/en-us/microsoftteams/what-are-phone-system-auto-attendants> <https://docs.microsoft.com/en-us/microsoftteams/create-a-phone-system-call-queue>

**NEW QUESTION 92**

- (Exam Topic 3)

You have a Microsoft 365 E3 subscription that uses Microsoft Teams.

You plan to deploy 20 conference phones that will support Direct Routing and one-touch join for Teams calendar meetings.

Which type of license do you require for each phone?

- A. Microsoft 365 Business Standard
- B. Microsoft Teams Rooms Standard
- C. Common Area Phone
- D. Microsoft 365 E3

**Answer:** A

**NEW QUESTION 97**

- (Exam Topic 3)

Your company has a Microsoft Office 365 subscription. The company has a Microsoft Teams group named Group1.

You need to remove inactive users from Group1. The members of Group1 must be validated every month. What should you use?

- A. supervision policies in the Security & Compliance admin center
- B. access reviews in the Azure Active Directory admin center
- C. eDiscovery cases in the Security & Compliance admin center
- D. usage reports in the Microsoft Teams admin center

**Answer:** B

**NEW QUESTION 101**

- (Exam Topic 3)

You plan to implement a pilot project on Phone System for 100 users. The pilot project will use a Microsoft Calling Plan.

You need to ensure that the users can establish calls to the PSTN. Which cmdlets should you run?

- A. Set-AzureADUserLicense, Set-CSUser, and Set-AzureADUser
- B. Grant-CsOnlineVoiceRoutingPolicy, Set-CsOnlineVoiceUser, and Set-CSUser
- C. Set-AzureADUser, Grant-CsOnlineVoiceRoutingPolicy, and Set-CsOnlineVoiceUser
- D. Set-AzureADUserLicense, Set-CsOnlineVoiceUser, and Set-CSUser

**Answer:** D

**Explanation:**

A Microsoft Calling plan requires an additional license. The three cmdlets in this answer assign a phone system license to the user, assigns a phone number to the user and enables the user for Enterprise Voice.

Reference:

<https://docs.microsoft.com/en-us/microsoftteams/calling-plans-for-office-365> <https://docs.microsoft.com/en-us/microsoftteams/set-up-calling-plans>

**NEW QUESTION 104**

- (Exam Topic 3)

Your company has a Microsoft 365 E5 subscription. You enable guest access for Microsoft Teams.

You need to prevent all users from downloading and opening files that contain malware by using Microsoft Teams channels.

What should you do first?

- A. From the Security & Compliance admin center, create a data loss prevention (DLP) policy.
- B. From the Azure Active Directory admin center, enable the End user protection baseline policy.
- C. From the Security & Compliance admin center, select Turn on ATP for SharePoint, OneDrive, and Microsoft Teams.
- D. From the Azure Active Directory admin center, add an identity provider.

**Answer:** C

**NEW QUESTION 107**

- (Exam Topic 3)

You have a Microsoft Office 365 subscription.

You need to prevent guest users from deleting channels from a Microsoft Teams team. What should you use?

- A. the Microsoft 365 admin center
- B. the Azure portal
- C. the Microsoft Teams client
- D. the Security & Compliance admin center

**Answer:** C

**Explanation:**

<https://support.microsoft.com/en-us/office/set-guest-permissions-for-channels-in-teams-4756c468-2746-4bfd-a5>

**NEW QUESTION 109**

- (Exam Topic 3)

You have a Microsoft Office 365 subscription named contoso.com.

You need to create the Microsoft Teams teams shown in the following table.

Name	Requirement
Sales	Users can join only once they are approved.
General	All contoso.com users are included automatically.
Projects	Users can join without approval.

What should you configure each team? To answer, drag the appropriate team types to the correct teams. Each team type may be used once, more than once, or not at all. You may need to drag the split bar between panes or scroll to view content.

NOTE: Each correct selection is worth one point.

**Team Types**

Org-wide

Private

Public

**Answer Area**

Sales: 

Team type

General: 

Team type

Project: 

Team type

- A. Mastered
- B. Not Mastered

**Answer:** A

**Explanation:**

Diagram Description automatically generated

Reference:

<https://docs.microsoft.com/en-us/microsoftteams/teams-channels-overview>

**NEW QUESTION 110**

- (Exam Topic 3)

You have a Microsoft 365 E5 subscription.

You plan to enable Phone System for Microsoft Teams. You need to configure the following:

- On-hold music
- A greeting message
- Call forwarding and simultaneous ringing to external phone numbers

Which two settings should you configure? To answer, select the appropriate settings in the answer area.

NOTE: Each correct selection is worth one point

**Answer Area**



- A. Mastered
- B. Not Mastered

**Answer:** A

**Explanation:**

Graphical user interface, application Description automatically generated

**NEW QUESTION 111**

- (Exam Topic 3)

Your company has a Microsoft 365 subscription.

You have a team that uses the following dynamic rule.

```
(user.department -contains "Sales" -or user.department -contains "Marketing") -and  
(user.userType -Contains "Guest") -and (user.country -eq "us")
```

Which user will be included in the group?

- A. A guest user in a department named Global Sales that has the country attribute set to USA.
- B. A member user in a department named Marketing Division that has the country attribute set to USA.
- C. A member user in a department named Marketing/Sales that has the country attribute set to US.
- D. A guest user in a department named US Marketing Division that has the country attribute set to US.

**Answer:** D

**Explanation:**

<https://docs.microsoft.com/en-us/azure/active-directory/users-groups-roles/groups-dynamic-membership>

**NEW QUESTION 116**

- (Exam Topic 3)

You have a Microsoft 365 E5 subscription that uses Microsoft Teams.

You need to enforce multi-factor authentication (MFA) for all users that access Microsoft Teams outside the corporate network.

What should you configure?

- A. a compliance policy
- B. a Teams policy
- C. a sign-in risk policy
- D. a Conditional Access policy

**Answer:** D

**Explanation:**

<https://learn.microsoft.com/en-us/azure/active-directory/conditional-access/howto-conditional-access-policy-all>

**NEW QUESTION 117**

- (Exam Topic 3)

Note: This question is part of a series of questions that present the same scenario. Each question in the series contains a unique solution that might meet the stated goals. Some question sets might have more than one correct solution, while others might not have a correct solution.

After you answer a question in this section, you will NOT be able to return to it. As a result, these questions will not appear in the review screen.

Your company has 10 offices in North America and Europe. The company has 5,000 users.

You plan to deploy Microsoft Teams for all the users. You run a pilot project for the planned deployment.

You need to identify the network packet loss from the pilot computers to Microsoft Teams during calls. Solution: From the Microsoft Teams admin center, you run the Network Planner.

Does this meet the goal?

A. Yes

B. No

**Answer: B**

**NEW QUESTION 121**

- (Exam Topic 3)

You company has a Microsoft 365 subscription that uses Phone System and Calling Plans. You plan to implement a toll phone number for the helpdesk.

You need to implement the following call features for the helpdesk phone number:

➤ Must include a greeting and hold music

➤ Must bypass menu options when a call is established to the helpdesk

What two resources should you create? Each correct answer presents part of the solution.

NOTE: Each correct selection is worth one point.

A. a call queue

B. a call park

C. an auto attendant

D. a resource account

E. a calling policy

**Answer: AC**

**Explanation:**

<https://docs.microsoft.com/en-us/microsoftteams/create-a-phone-system-call-queue> <https://docs.microsoft.com/en-us/microsoftteams/teams-calling-policy>

**NEW QUESTION 125**

- (Exam Topic 3)

Your company has a Microsoft 365 subscription that contains a Microsoft Teams auto attendant. Calls to the auto attendant will be redirected to a shared voicemail.

You need to create a group for the shared voicemail. Which type of group should you create?

A. mail-enabled security

B. distribution

C. security

D. Microsoft 365

**Answer: D**

**Explanation:**

Reference:

<https://docs.microsoft.com/en-us/microsoftteams/create-a-phone-system-auto-attendant>

**NEW QUESTION 126**

.....

## Thank You for Trying Our Product

\* 100% Pass or Money Back

All our products come with a 90-day Money Back Guarantee.

\* One year free update

You can enjoy free update one year. 24x7 online support.

\* Trusted by Millions

We currently serve more than 30,000,000 customers.

\* Shop Securely

All transactions are protected by VeriSign!

**100% Pass Your MS-700 Exam with Our Prep Materials Via below:**

<https://www.certleader.com/MS-700-dumps.html>